

HSE ROHS

REV	ECN NO	DESCRIPTION	DATE	NAME
A		NEW		

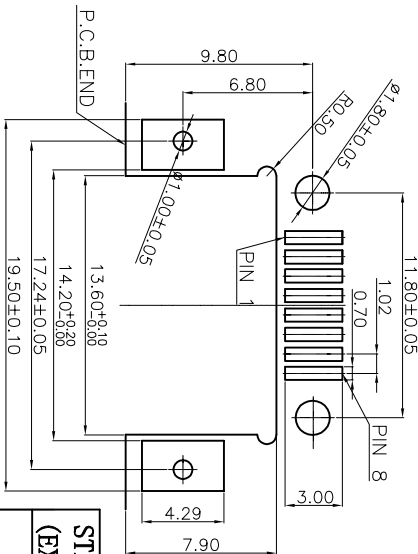
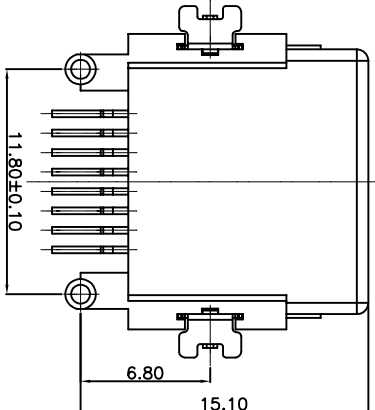
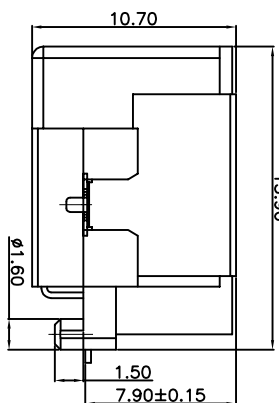
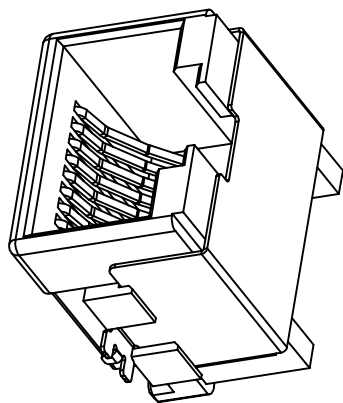
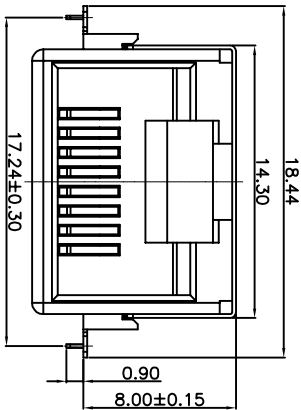
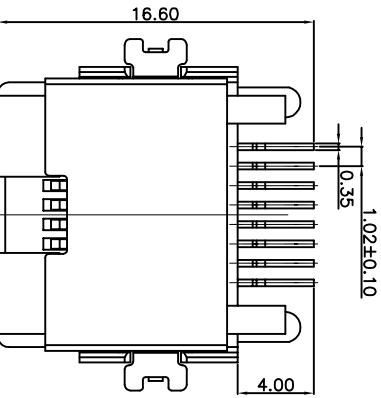

RECOMMEND P.C.B Layout (T=1.20mm)
PCB TOLERANCE:±0.05

- NOTE:
- 1: MATERIAL:
- <1> SHIELD: BRASS, T=0.2mm
 - <2> HOUSING: LCP, G/F FILLED, UL94V-0 RATED OR OTHER HIGH PERFORMANCE RESINS. COLOR IN BLACK.
 - <3> TERMINAL: PHOSPHOR BRONZE, T=0.30mm
 - 2: CONTACT PLATED: GOLD
 - 3: PCB TOLERANCES: DIMENSION ±0.05
 - 4: RETENTION FORCE OF PLUG IN THE JACK IS 10 kgf (min).
 - 5: SPECIFICATION:

DIELECTRIC STRENGTH: AC 500V FOR ONE MINUTE
INSULATION RESISTANCE: 100MΩ min. AT DC 100V
CONTACT RESISTANCE: 45mΩ max.
CURRENT RATING: 500mA
OPERATING TEMPERATURE: -30℃~+85℃

Ordering Information

L600XX - X X XX X

insulation height 80-8.0
1=Forward
2=Reverse

Material
Option
3=NY6T
4=LCP

Serial No. 01-99
C=Tray
D=Reel

Packing
C=Tray
D=Reel

STANDARD TOLERANCE (EXCEPT SPECIFIED)	LINER	ANGLES
0 ±0.30	0.°	±3°
.00 ±0.25	.0°	±2°
.000 ±0.15	.00°	±1°

LDCONN 东莞连大精密制品有限公司		Dongguan LianDa Precision Products Co., LTD	
TITLE	R745 8P8C Sinking board type 18.0 SWT Reverse	DRAWN BY	LuJunhui
PART NO	L60080-240XC	CHECKED BY	
DRAWING NO		APPROVED BY	
SCALE	1:1	UNIT	mm
		PAGE	1/1
		SIZE	A4