

HSF RoHS

REV	ECN NO	DESCRIPTION	DATE	NAME
A	—	NEW	11/21-'19	LZM

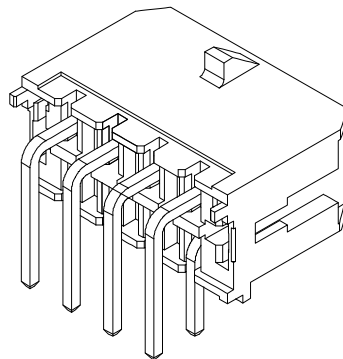
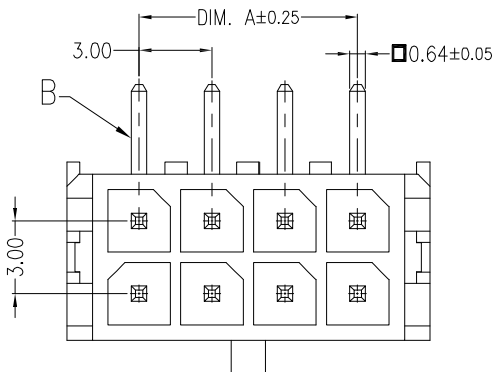

Pin NO.	Dimensions (mm)	
	DIM. A	DIM. B
2*03	6.00	12.05
2*04	9.00	15.05

主要技术参数 Main Specifications

线数 (Poles) :02 to 24
 接触电阻 (Contact resistance): $\leq 10\text{m}\Omega$
 绝缘电阻 (Insulation resistance): $\geq 1000\text{M}\Omega$
 额定电压 (Rated voltage):250V AC DC
 额定电流 (Rated current):5.0A AC DC
 耐电压 (Withstand Voltage):1500V AC/minute
 温度范围 (Temperature Range):-25°C~+85°C

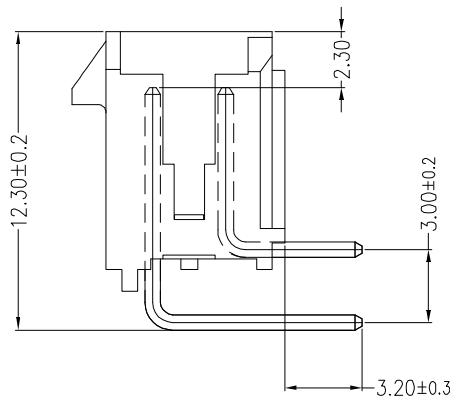
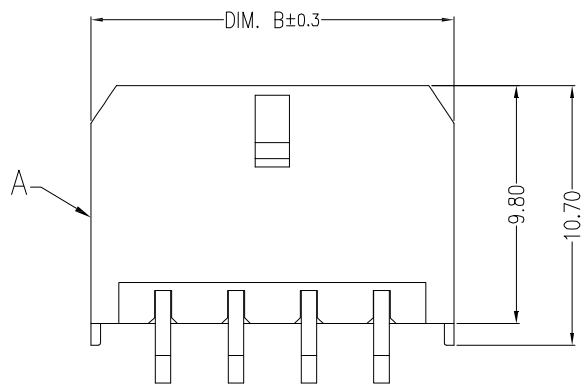

ORDER INFORMATION:

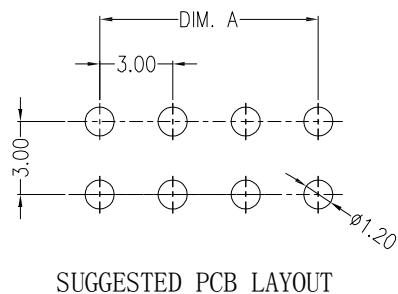
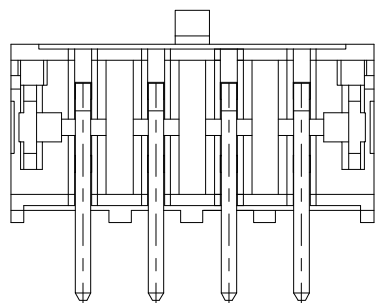
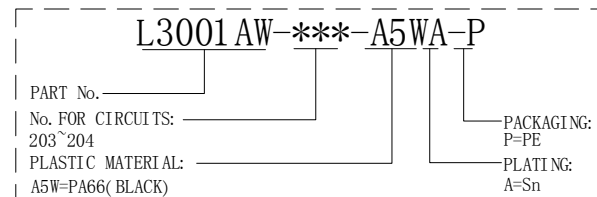

ITEM	COMPONENT	Q'TY	MATERIAL	FINISH
B	CONTACT	2*3~2*4PCS	Brass	Sn-plated
A	PEDESTAL	1 PCS	PA66	UL 94V-0, COLOR:BLACK

STANDARD TOLERANCE (EXCEPT SPECIFIED)

LINER	ANGLES
.0 ±0.30	0.° ±3°
.00 ±0.20	.0° ±2°
.000 ±0.10	.00° ±1°

LDCONN 东莞连大精密制品有限公司 DongGuan LianDa Precision Products Co., LTD									
TITLE	A3001AW (MX3.0 Curved Needle)	DRAWN BY	LZM	11/21-'19					
PART NO	L3001AW-***-A5WA-P	CHECKED BY							
DRAWING NO	—		APPROVED BY						
SCALE	1:1	UNIT	mm	PAGE	1/1	SIZE	A4		