

HSF RoHS

REV	ECN NO	DESCRIPTION	DATE	NAME
A	—	NEW	11/21-'19	LZM

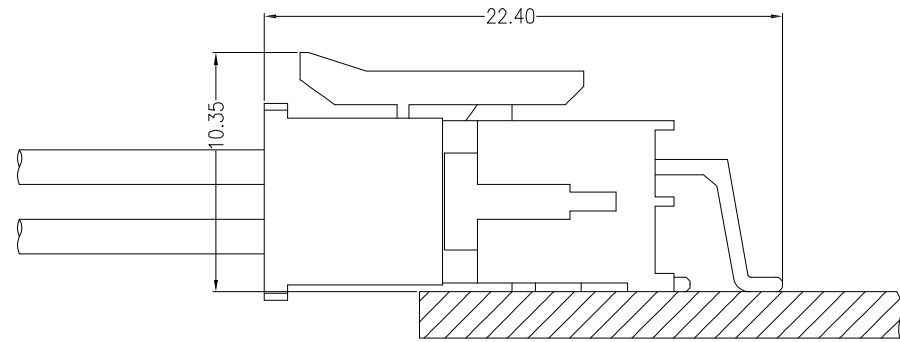

Assembly Layout

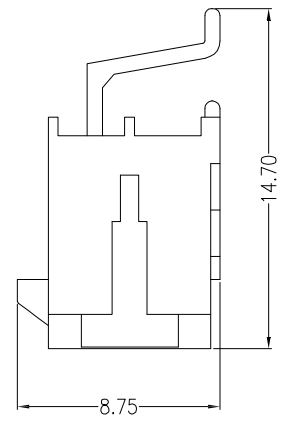
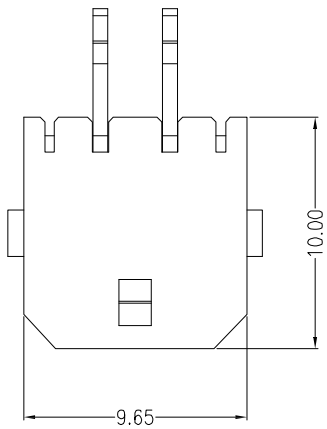
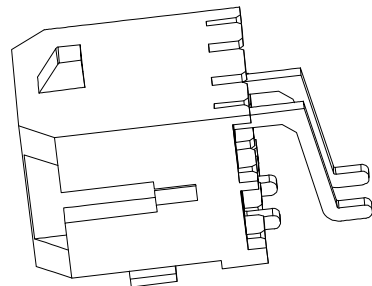
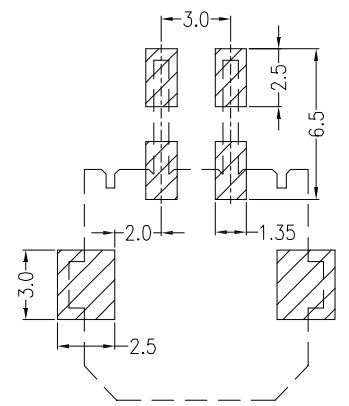
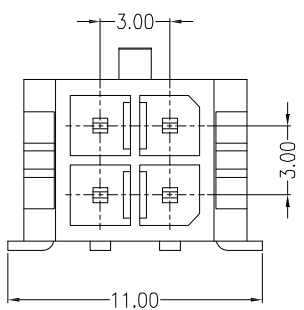

主要技术参数 Main Specifications

- 线数 (Poles) :02
- 接触电阻 (Contact resistance): ≤20m Ω
- 绝缘电阻 (Insulation resistance): ≥1000M Ω
- 额定电压 (Rated voltage): 250V AC DC
- 额定电流 (Rated current): 5A AC DC
- 耐电压 (Withstand Voltage): 1500V AC/minute
- 温度范围 (Temperature Range): -25°C~+105°C

ORDER INFORMATION:

L3001AWR-202-F2MA-R

PART No. _____
 No. OF CIRCUITS: _____
 202 _____
 PLASTIC MATERIAL: _____
 F2M=LCP(BEIGE) _____

PACKAGING:
 R=REEL
 P=PE
 PLATING:
 A=Sn

Mating PCB detail I

LDCONN 东莞连大精密制品有限公司
 连大 DongGuan LianDa Precision Products Co., LTD

NO.	DESCRIPTION	QTY	MATERIAL	PLATING/COLOR
A	Insulator	1	LCP(UL94V-0)	Black
B	Contacts	4	Brass	Tin-plated
C	Solder Tab	2	Brass	Tin-plated

STANDARD TOLERANCE (EXCEPT SPECIFIED)	
LINER	ANGLES
.0 ±0.30	0.° ±3°
.00 ±0.20	.0° ±2°
.000 ±0.10	.00° ±1°

TITLE	A3001AWR-202 Double Row	DRAWN BY	LZM	11/21-'19
PART NO	L3001AWR-202-F2MA-R	CHECKED BY		
DRAWING NO	—	APPROVED BY		
SCALE	1:1	UNIT	mm	PAGE 1/1
				SIZE A4