

HSF RoHS

REV	ECN NO	DESCRIPTION	DATE	NAME
A		NEW	06/08-'22	LJS

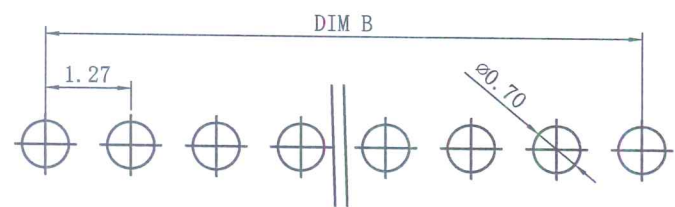
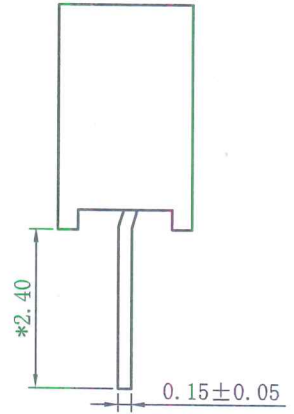
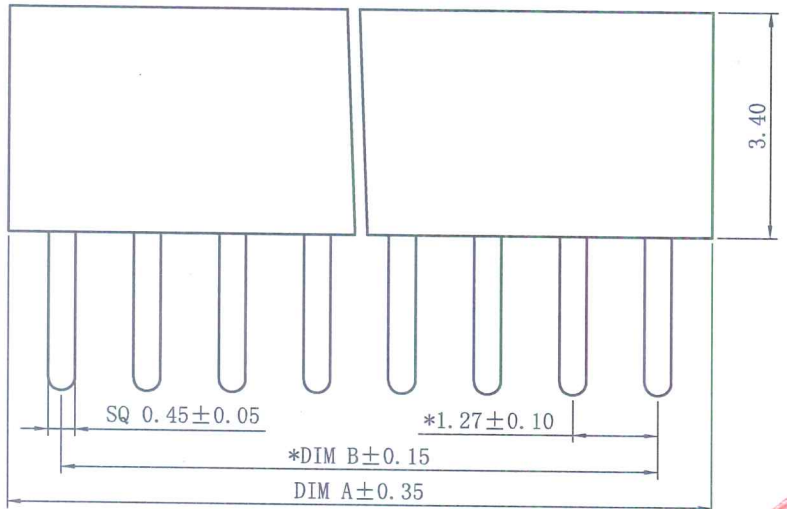
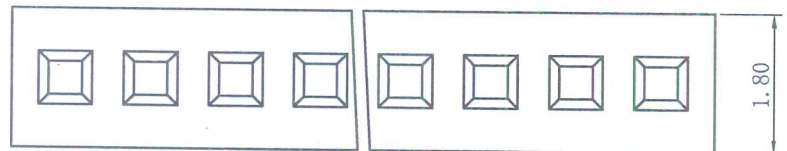

PCB LAYOUT

Specifications

- 规范
- Current Rating: 1.0Amps
额定电流: 1.0安培
 - rated voltage: 125V AC/DC
额定电压: 125V AC/DC
 - Insulation Resistance: 1000 MΩ Min
绝缘电阻: 最小1000 MΩ
 - Dielectric withstanding Voltage: 500V AC
耐电压: 500V AC
 - Contact Resistance: 20 mΩ Max
接触电阻: 最大20 mΩ
 - Operating Temperature: -40° C to +105° C
工作温度: -40° C ~ +105° C
 - Contact Material: Phosphor Bronze
接触材质: 磷铜
 - Plating: AU G/F
电镀: 金 G/F
 - Insulation Material: PA6T, UL94V-0
绝缘材料: PA6T, UL94V-0
 - Marked "*" symbol are major dimensions
标有 "*" 符号为主要尺寸
 - Packing: Tray
包装: 盘装

Ordering Information

LPH 127 X XX X XXXX

Code	Pitch	Rows	PIN Number	Packing	Serial No
PH: 排针	100: 1.0	1: 单排	1~99	A: 袋装	0001~9999
FH: 排母	127: 1.27	2: 双排 (单排的PIN数)		B: 管装	
BH: 筒牛	200: 2.0	3: 三排		C: 盘装	
BH: 筒牛	250: 2.5	4: 四排		D: 卷装	
BH: 筒牛	254: 2.54			E: 袋加盒	
				F: 其它	

PIN	DIM A	DIM B
1x1P	1.77	
1x2P	3.04	1.27
1x3P	4.31	2.54
1x4P	5.58	3.81
1x5P	6.85	5.08
1x6P	8.12	6.35
1x7P	9.39	7.62
1x8P	10.66	8.89
1x9P	11.93	10.16
1x10P	13.20	11.43
1x11P	14.47	12.70
1x12P	15.74	13.97
1x13P	17.01	15.24
1x14P	18.28	16.51
1x15P	19.55	17.78
1x16P	20.82	19.05
1x17P	22.09	20.32
1x18P	23.36	21.59
1x19P	24.63	22.86
1x20P	25.90	24.13
1x21P	27.17	25.4
1x22P	28.44	26.67
1x23P	29.71	27.94
1x24P	30.98	29.21
1x25P	32.25	30.48
1x26P	33.52	31.75
1x27P	34.79	33.02
1x28P	36.06	34.29
1x29P	37.33	35.56
1x30P	38.60	36.83
1x31P	39.87	38.10
1x32P	41.14	39.37
1x33P	42.41	40.64
1x34P	43.68	41.91
1x35P	44.95	43.18
1x36P	46.22	44.45
1x37P	47.49	45.72
1x38P	48.76	46.99
1x39P	50.03	48.26
1x40P	51.30	49.53



LDCONN 东莞连大精密制品有限公司
DongGuan LianDa Precision Products Co., LTD

STANDARD TOLERANCE (EXCEPT SPECIFIED)	
LINER	ANGLES
.0 ±0.30	0.° ±3°
.00 ±0.20	.0° ±2°
.000 ±0.10	.00° ±1°

TITLE	PH1.27X3.4 1X4P 180°单排排母U型PC2.4	DRAWN BY	LJS	06/08-'22
PART NO.	LFH127104C0001	CHECKED BY	KJL	8/31-22
DRAWING NO.		APPROVED BY	ZX	8/31-22
SCALE		UNIT	mm	PAGE
				SIZE
				A 4

REV	ECN NO	DESCRIPTION	DATE	NAME
A		NEW	05/13-'22	LZR

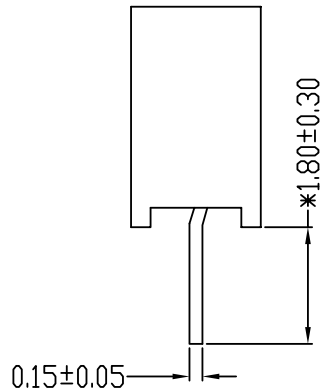
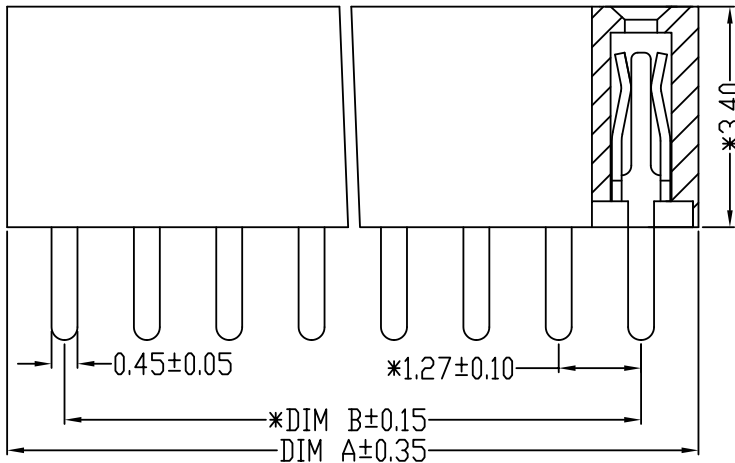
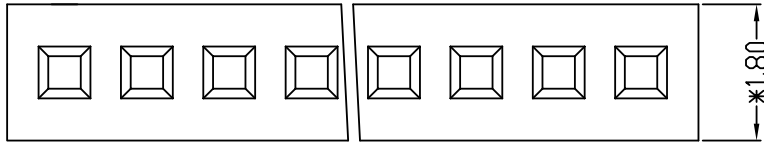

Specifications

- 规范
- Current Rating: 1.0Amps
额定电流:1.0安培
 - rated voltage: 125V AC/DC
额定电压:125V AC/DC
 - Insulation Resistance: 1000 MΩ Min
绝缘电阻:最小1000 MΩ
 - Dielectric withstanding Voltage: 500V AC
耐电压:500V AC
 - Contact Resistance: 20 mΩ Max
接触电阻:最大20 mΩ
 - Operating Temperature: -40° C to+105° C
工作温度:-40° C ~ +105° C
 - Contact Material: Phosphor Bronze
接触材质:磷铜
 - Plating: Au G/F
电镀:金 G/F
 - Insulation Material: PA6T, UL94V-0
绝缘材料:PA6T, UL94V-0
 - Marked "*" symbol are major dimensions
标有 "*" 符号为主要尺寸
 - Packing: 2000Bag+Box;
包装: 2000袋+盒;

PIN	DIM A	DIM B
1x1P	1.67	
1x2P	2.94	1.27
1x3P	4.21	2.54
1x4P	5.48	3.81
1x5P	6.75	5.08
1x6P	8.02	6.35
1x7P	9.29	7.62
1x8P	10.56	8.89
1x9P	11.83	10.16
1x10P	13.10	11.43
1x11P	14.37	12.70
1x12P	15.64	13.97
1x13P	16.91	15.24
1x14P	18.18	16.51
1x15P	19.45	17.78
1x16P	20.72	19.05
1x17P	21.99	20.32
1x18P	23.26	21.59
1x19P	24.53	22.86
1x20P	25.80	24.13
1x21P	27.07	25.4
1x22P	28.34	26.67
1x23P	29.61	27.94
1x24P	30.88	29.21
1x25P	32.15	30.48
1x26P	33.42	31.75
1x27P	34.69	33.02
1x28P	35.96	34.29
1x29P	37.23	35.56
1x30P	38.50	36.83
1x31P	39.77	38.10
1x32P	41.04	39.37
1x33P	42.31	40.64
1x34P	43.58	41.91
1x35P	44.85	43.18
1x36P	46.12	44.45
1x37P	47.39	45.72
1x38P	48.66	46.99
1x39P	49.93	48.26
1x40P	51.20	49.53

Ordering Information

LFH 127 X XX X XXXX

Code	Pitch	Rows	PIN Number	Packing	Serial No
FH: FEMALE HEADER 排母	100: 1.0 127: 1.27 200: 2.0 250: 2.5 254: 2.54	1: 1Row单排 2: 2Row双排 3: 3Row三排 (Per Row每排) 4: 4Row四排	1~99 (Per Row每排)	A: PE Bag 袋装 B: Tube 管装 C: Tray 盘装 D: Reel 卷装 E: Bag and Box 袋加盒 F: Other其他	0001~9999

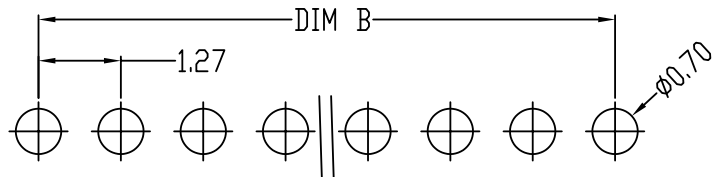

PCB LAYOUT

STANDARD TOLERANCE (EXCEPT SPECIFIED)	
LINER	ANGLES
.0 ±0.30	0.° ±3°
.00 ±0.20	.0° ±2°
.000 ±0.10	.00° ±1°

LDCONN 东莞连大精密制品有限公司
DongGuan LianDa Precision Products Co., LTD

TITLE	PH1.27X3.4 1X4P 180° 单排排母U型	DRAWN BY	LZR	05/13-'22
PART NO	LFH127104E0001	CHECKED BY	工程 7-11-22 朱磊	
DRAWING NO		APPROVED BY	工程 7-11-22 周晓	
SCALE	1:1	UNIT	mm	PAGE 1/1
				SIZE A4

REV	ECN NO	DESCRIPTION	DATE	NAME
A		NEW	05/13-'22	LZR

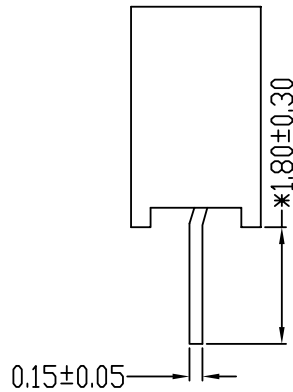
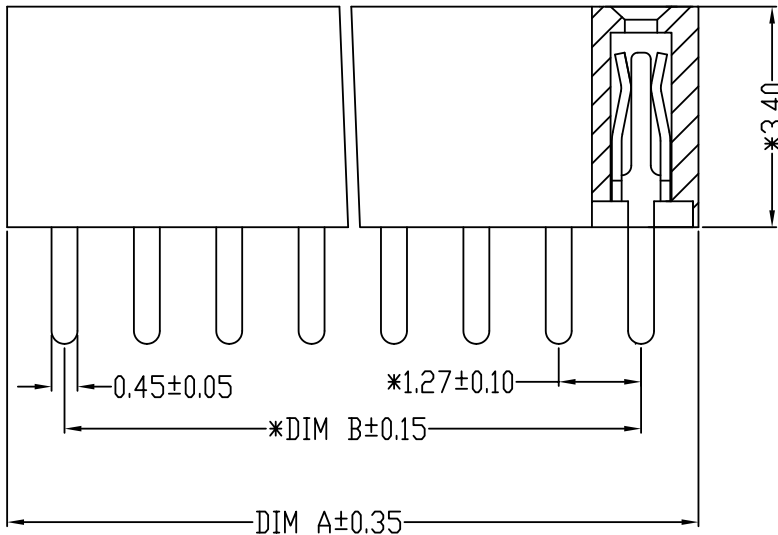
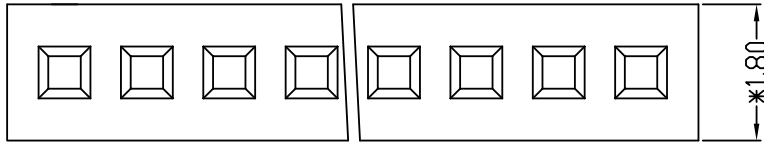

Specifications

- 规范
- Current Rating: 1.0Amps
额定电流:1.0安培
 - rated voltage: 125V AC/DC
额定电压:125V AC/DC
 - Insulation Resistance: 1000 MΩ Min
绝缘电阻:最小1000 MΩ
 - Dielectric withstanding Voltage: 500V AC
耐压:500V AC
 - Contact Resistance: 20 mΩ Max
接触电阻:最大20 mΩ
 - Operating Temperature: -40° C to+105° C
工作温度:-40° C ~ +105° C
 - Contact Material: Phosphor Bronze
接触材质:磷铜
 - Plating: Au G/F
电镀:金 G/F
 - Insulation Material: PA6T, UL94V-0
绝缘材料:PA6T, UL94V-0
 - Marked "*" symbol are major dimensions
标有 "*" 符号为主要尺寸
 - Packing: 1500Bag+Box;
包装: 1500袋+盒;

PIN	DIM A	DIM B
1x1P	1.67	1.27
1x2P	2.94	1.27
1x3P	4.21	2.54
1x4P	5.48	3.81
1x5P	6.75	5.08
1x6P	8.02	6.35
1x7P	9.29	7.62
1x8P	10.56	8.89
1x9P	11.83	10.16
1x10P	13.10	11.43
1x11P	14.37	12.70
1x12P	15.64	13.97
1x13P	16.91	15.24
1x14P	18.18	16.51
1x15P	19.45	17.78
1x16P	20.72	19.05
1x17P	21.99	20.32
1x18P	23.26	21.59
1x19P	24.53	22.86
1x20P	25.80	24.13
1x21P	27.07	25.4
1x22P	28.34	26.67
1x23P	29.61	27.94
1x24P	30.88	29.21
1x25P	32.15	30.48
1x26P	33.42	31.75
1x27P	34.69	33.02
1x28P	35.96	34.29
1x29P	37.23	35.56
1x30P	38.50	36.83
1x31P	39.77	38.10
1x32P	41.04	39.37
1x33P	42.31	40.64
1x34P	43.58	41.91
1x35P	44.85	43.18
1x36P	46.12	44.45
1x37P	47.39	45.72
1x38P	48.66	46.99
1x39P	49.93	48.26
1x40P	51.20	49.53

Ordering Information

LFH 127 X XX X XXXX

Code FH:FEMALE HEADER 排母	Pitch 100: 1.0 127: 1.27 200: 2.0 250: 2.5 254: 2.54	Rows 1: 1Row单排 2: 2Row双排 3: 3Row三排 4: 4Row四排	PIN Number PIN数 1~99 (Per Row每排)	Packing A: PE Bag 袋装 B: Tube 管装 C: Tray 盘装 D: Reel 卷装 E: Bag and Box 袋加盒 F: Other其他	Serial No 0001~9999
-----------------------------	---	--	---	---	------------------------

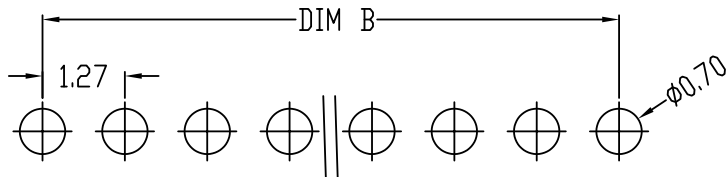

PCB LAYOUT

STANDARD TOLERANCE (EXCEPT SPECIFIED)	
LINER	ANGLES
.0 ±0.30	0.° ±3°
.00 ±0.20	.0° ±2°
.000 ±0.10	.00° ±1°

LDCONN 东莞连大精密制品有限公司
DongGuan LianDa Precision Products Co., LTD

TITLE	PH1.27X3.4 1X7P 180° 单排排母U型	DRAWN BY	LZR	05/13-'22
PART NO	LFH127107E0001	CHECKED BY	工程 7-11-22 朱磊	
DRAWING NO		APPROVED BY	工程 7-11-22 周晓	
SCALE	1:1	UNIT	mm	PAGE 1/1
				SIZE A4

HSF RoHS

REV	ECN NO	DESCRIPTION	DATE	NAME
A		NEW	08/29-'17	WZG
B		旧料号: L30334-2003101C	09/09-'22	KJL

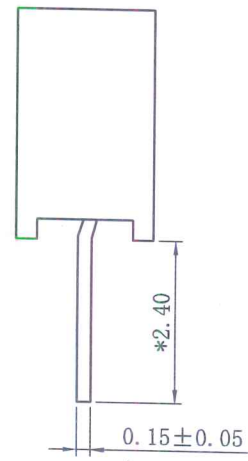
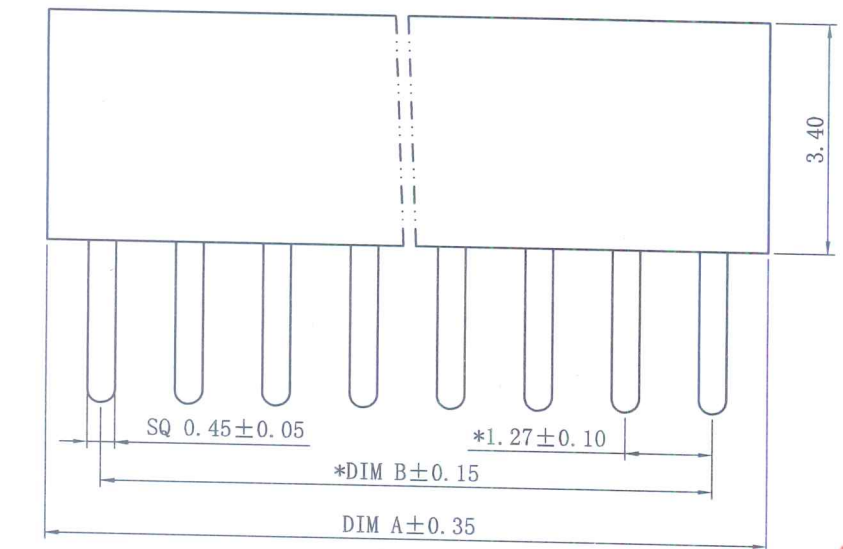
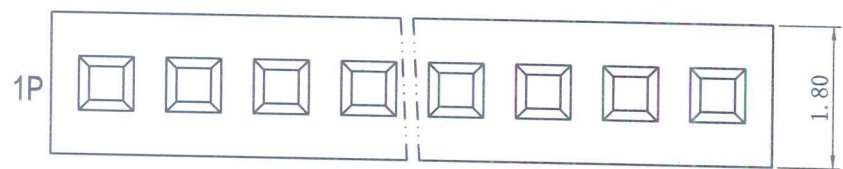

Specifications

- 规范
- Current Rating: 1.0Amps
额定电流:1.0安培
 - rated voltage: 125V AC/DC
额定电压:125V AC/DC
 - Insulation Resistance: 1000 MΩ Min
绝缘电阻:最小1000 MΩ
 - Dielectric withstanding Voltage: 500V AC
耐电压:500V AC
 - Contact Resistance: 20 mΩ Max
接触电阻:最大20 mΩ
 - Operating Temperature: -40°C to +105°C
工作温度:-40°C ~ +105°C
 - Contact Material: Phosphor Bronze
接触材质:磷铜
 - Plating: AU G/F Over Ni
电镀: 金 G/F 镍底
 - Insulation Material: PA6T, UL94V-0, Black
绝缘材料: PA6T, UL94V-0, 黑色
 - Marked "*" symbol are major dimensions
标有 "*" 符号为为主要尺寸
 - Packing: 300PCS/Bag+Box
包装: 300PCS/袋+盒

PIN	DIM A	DIM B
1x1P	1.77	
1x2P	3.04	1.27
1x3P	4.31	2.54
1x4P	5.58	3.81
1x5P	6.85	5.08
1x6P	8.12	6.35
1x7P	9.39	7.62
1x8P	10.66	8.89
1x9P	11.93	10.16
1x10P	13.20	11.43
1x11P	14.47	12.70
1x12P	15.74	13.97
1x13P	17.01	15.24
1x14P	18.28	16.51
1x15P	19.55	17.78
1x16P	20.82	19.05
1x17P	22.09	20.32
1x18P	23.36	21.59
1x19P	24.63	22.86
1x20P	25.90	24.13
1x21P	27.17	25.40
1x22P	28.44	26.67
1x23P	29.71	27.94
1x24P	30.98	29.21
1x25P	32.25	30.48
1x26P	33.52	31.75
1x27P	34.79	33.02
1x28P	36.06	34.29
1x29P	37.33	35.56
1x30P	38.60	36.83
1x31P	39.87	38.10
1x32P	41.14	39.37
1x33P	42.41	40.64
1x34P	43.68	41.91
1x35P	44.95	43.18
1x36P	46.22	44.45
1x37P	47.49	45.72
1x38P	48.76	46.99
1x39P	50.03	48.26
1x40P	51.30	49.53

Ordering Information

LFH 127 X XX X XXXX

Code	Pitch	Rows	PIN Number	Packing	Serial No
PH: PIN HEADER 排针	100: 1.0	1: 1Row单排	PIN数	A: PE Bag 袋装	0001~9999
FH: FEMALE HEADER 排母	127: 1.27	2: 2Row双排	1~99	B: Tube 管装	
BH: EJECTOR HEADER 筒牛	200: 2.0	3: 3Row三排	(Per Row每排)	C: Tray 盘装	
EH: BOX HEADER 牛角	250: 2.5	4: 4Row四排		D: Reel 卷装	
	254: 2.54			E: Bag and Box 袋加盒	
				F: Other其他	

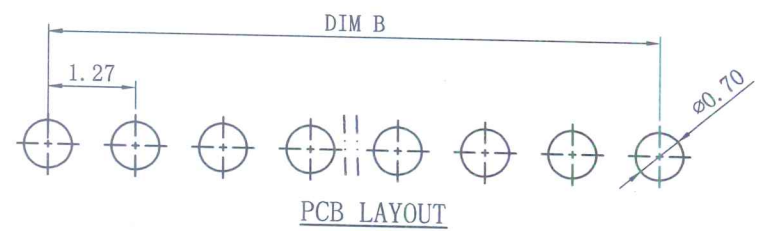

STANDARD TOLERANCE (EXCEPT SPECIFIED)	
LINER	ANGLES
.0 ±0.30	0.° ±3°
.00 ±0.20	.0° ±2°
.000 ±0.10	.00° ±1°

LDCONN 东莞连大精密制品有限公司
DongGuan LianDa Precision Products Co., LTD

TITLE	PH1.27X3.4 1X20P 180°单排排母U型	DRAWN BY	KJL	DATE	09/09-'22
PART NO.	LFH127120C0001	CHECKED BY	ZL	9/9-22	
DRAWING NO.		APPROVED BY	ZX	9/9-22	
SCALE		UNIT	mm	PAGE	
			SIZE	A4	

REV	ECN NO	DESCRIPTION	DATE	NAME
A		NEW	05/13-'22	LZR

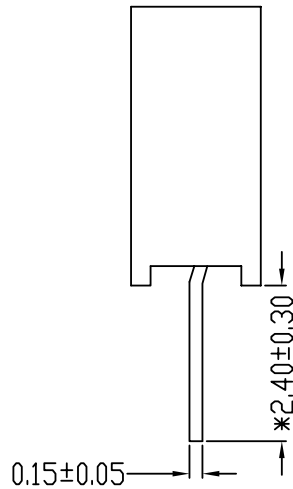
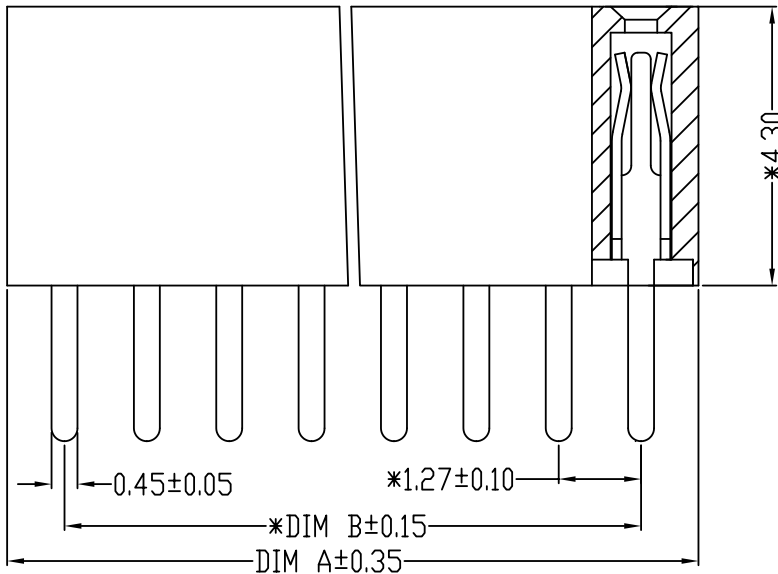
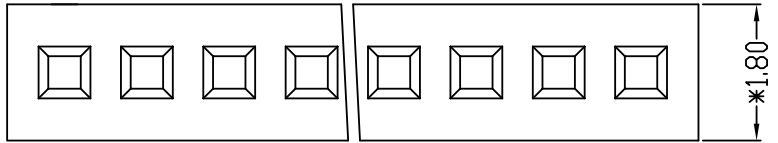

Specifications

- 规范
- Current Rating: 1.0Amps
额定电流:1.0安培
 - rated voltage: 125V AC/DC
额定电压:125V AC/DC
 - Insulation Resistance: 1000 MΩ Min
绝缘电阻:最小1000 MΩ
 - Dielectric withstanding Voltage: 500V AC
耐电压:500V AC
 - Contact Resistance: 20 mΩ Max
接触电阻:最大20 mΩ
 - Operating Temperature: -40° C to+105° C
工作温度:-40° C ~ +105° C
 - Contact Material: Phosphor Bronze
接触材质:磷铜
 - Plating: Au G/F
电镀:金 G/F
 - Insulation Material: PA6T, UL94V-0
绝缘材料:PA6T, UL94V-0
 - Marked "*" symbol are major dimensions
标有 "*" 符号为主要尺寸
 - Packing: 500Bag+Box;
包装: 500袋+盒;

PIN	DIM A	DIM B
1x1P	1.67	
1x2P	2.94	1.27
1x3P	4.21	2.54
1x4P	5.48	3.81
1x5P	6.75	5.08
1x6P	8.02	6.35
1x7P	9.29	7.62
1x8P	10.56	8.89
1x9P	11.83	10.16
1x10P	13.10	11.43
1x11P	14.37	12.70
1x12P	15.64	13.97
1x13P	16.91	15.24
1x14P	18.18	16.51
1x15P	19.45	17.78
1x16P	20.72	19.05
1x17P	21.99	20.32
1x18P	23.26	21.59
1x19P	24.53	22.86
1x20P	25.80	24.13
1x21P	27.07	25.4
1x22P	28.34	26.67
1x23P	29.61	27.94
1x24P	30.88	29.21
1x25P	32.15	30.48
1x26P	33.42	31.75
1x27P	34.69	33.02
1x28P	35.96	34.29
1x29P	37.23	35.56
1x30P	38.50	36.83
1x31P	39.77	38.10
1x32P	41.04	39.37
1x33P	42.31	40.64
1x34P	43.58	41.91
1x35P	44.85	43.18
1x36P	46.12	44.45
1x37P	47.39	45.72
1x38P	48.66	46.99
1x39P	49.93	48.26
1x40P	51.20	49.53

Ordering Information

LFH 127 X XX X XXXX

Code	Pitch	Rows	PIN Number	Packing	Serial No
FH:FEMALE HEADER 排母	100:1.0 127:1.27 200:2.0 250:2.5 254:2.54	1:1Row单排 2:2Row双排 3:3Row三排 4:4Row四排	1~99 (Per Row每排)	A:PE Bag 袋装 B:Tube 管装 C:Troy 盘装 D:Reel 卷装 E:Bag and Box 袋加盒 F:Other其他	0001~9999

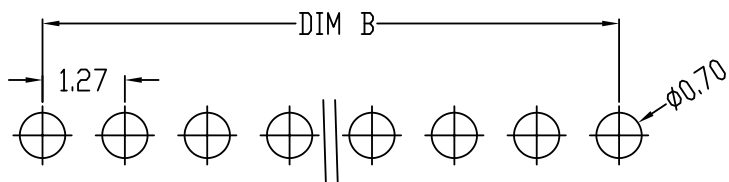

PCB LAYOUT

STANDARD TOLERANCE (EXCEPT SPECIFIED)	
LINER	ANGLES
.0 ±0.30	0.° ±3°
.00 ±0.20	.0° ±2°
.000 ±0.10	.00° ±1°

LDCONN 东莞连大精密制品有限公司
DongGuan LianDa Precision Products Co., LTD

TITLE	PH1.27X4.3 1X10P 180°单排排母U型	DRAWN BY	LZR	05/13-'22
PART NO	LFH127110C0001	CHECKED BY	工程 7-11-22 朱磊	
DRAWING NO		APPROVED BY	工程 7-11-22 周晓	
SCALE	1:1	UNIT	mm	PAGE 1/1
				SIZE A4

REV	ECN NO	DESCRIPTION	DATE	NAME
A		NEW	05/13-'22	LZR

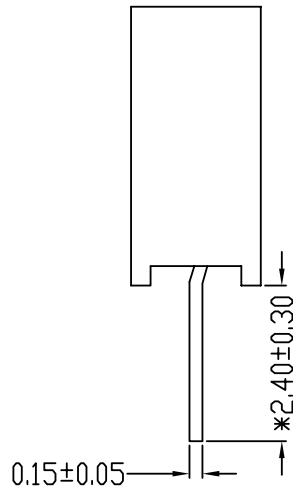
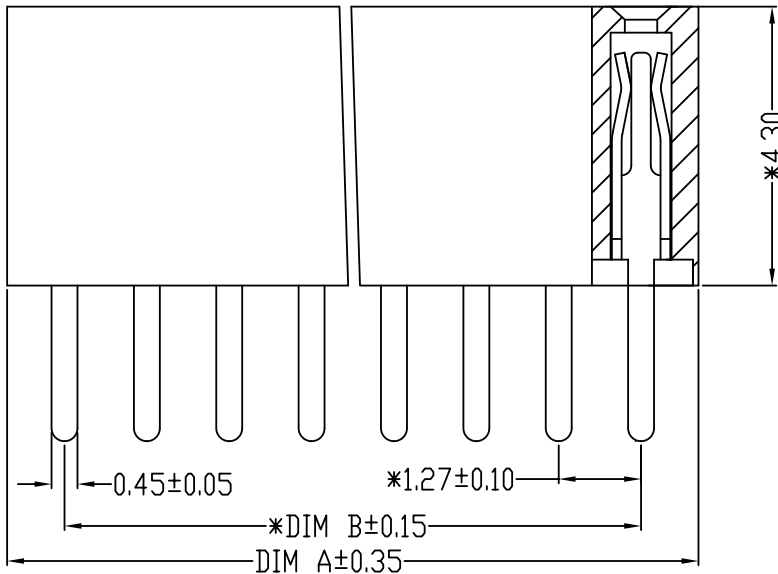
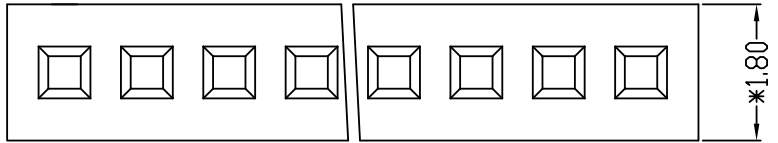

Specifications

- 规范
- Current Rating: 1.0Amps
额定电流:1.0安培
 - rated voltage: 125V AC/DC
额定电压:125V AC/DC
 - Insulation Resistance: 1000 MΩ Min
绝缘电阻:最小1000 MΩ
 - Dielectric withstanding Voltage: 500V AC
耐电压:500V AC
 - Contact Resistance: 20 mΩ Max
接触电阻:最大20 mΩ
 - Operating Temperature: -40° C to+105° C
工作温度:-40° C ~ +105° C
 - Contact Material: Phosphor Bronze
接触材质:磷铜
 - Plating: Au G/F
电镀:金 G/F
 - Insulation Material: PA6T, UL94V-0
绝缘材料:PA6T, UL94V-0
 - Marked "*" symbol are major dimensions
标有 "*" 符号为主要尺寸
 - Packing: Tray;
包装: 800PCS/盘;

PIN	DIM A	DIM B
1x1P	1.67	
1x2P	2.94	1.27
1x3P	4.21	2.54
1x4P	5.48	3.81
1x5P	6.75	5.08
1x6P	8.02	6.35
1x7P	9.29	7.62
1x8P	10.56	8.89
1x9P	11.83	10.16
1x10P	13.10	11.43
1x11P	14.37	12.70
1x12P	15.64	13.97
1x13P	16.91	15.24
1x14P	18.18	16.51
1x15P	19.45	17.78
1x16P	20.72	19.05
1x17P	21.99	20.32
1x18P	23.26	21.59
1x19P	24.53	22.86
1x20P	25.80	24.13
1x21P	27.07	25.4
1x22P	28.34	26.67
1x23P	29.61	27.94
1x24P	30.88	29.21
1x25P	32.15	30.48
1x26P	33.42	31.75
1x27P	34.69	33.02
1x28P	35.96	34.29
1x29P	37.23	35.56
1x30P	38.50	36.83
1x31P	39.77	38.10
1x32P	41.04	39.37
1x33P	42.31	40.64
1x34P	43.58	41.91
1x35P	44.85	43.18
1x36P	46.12	44.45
1x37P	47.39	45.72
1x38P	48.66	46.99
1x39P	49.93	48.26
1x40P	51.20	49.53

Ordering Information

LFH 127 X XX X XXXX

Code	Pitch	Rows	PIN Number	Packing	Serial No
FH:FEMALE HEADER 排母	100:1.0 127:1.27 200: 2.0 250:2.5 254: 2.54	1:1Row单排 2:2Row双排 3:3Row三排 4:4Row四排	1~99 (Per Row每排)	A:PE Bag 袋装 B:Tube 管装 C:Tray 盘装 D:Reel 卷装 E:Bag and Box 袋加盒 F:Other其他	0001~9999

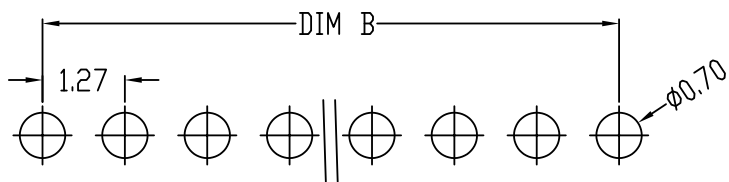

PCB LAYOUT

STANDARD TOLERANCE (EXCEPT SPECIFIED)	
LINER	ANGLES
.0 ±0.30	0.° ±3°
.00 ±0.20	.0° ±2°
.000 ±0.10	.00° ±1°

LDCONN 东莞连大精密制品有限公司
DongGuan LianDa Precision Products Co., LTD

TITLE	PH1.27X4.3 1X14P 180°单排排母U型	DRAWN BY	LZR	05/13-'22
PART NO	LFH127114A0001	CHECKED BY	工程 7-11-22 朱磊	
DRAWING NO		APPROVED BY	工程 7-11-22 周晓	
SCALE	1:1	UNIT	mm	PAGE 1/1
				SIZE A4

REV	ECN NO	DESCRIPTION	DATE	NAME
A		NEW	05/13-'22	LZR

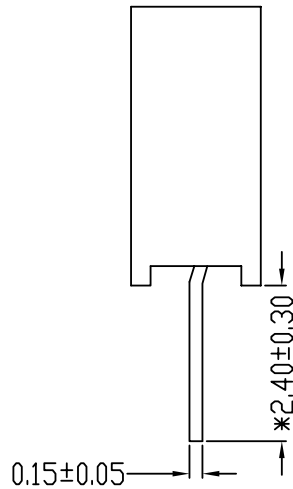
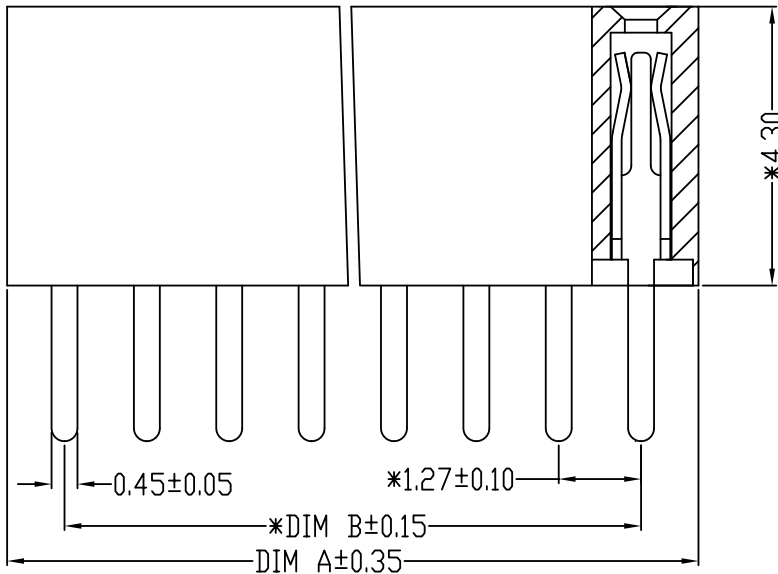
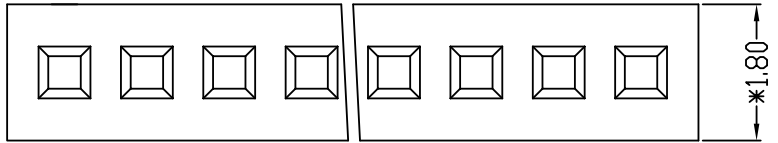

Specifications

- 规范
- Current Rating: 1.0Amps
额定电流:1.0安培
 - rated voltage: 125V AC/DC
额定电压:125V AC/DC
 - Insulation Resistance: 1000 MΩ Min
绝缘电阻:最小1000 MΩ
 - Dielectric withstanding Voltage: 500V AC
耐压:500V AC
 - Contact Resistance: 20 mΩ Max
接触电阻:最大20 mΩ
 - Operating Temperature: -40° C to +105° C
工作温度:-40° C ~ +105° C
 - Contact Material: Phosphor Bronze
接触材质:磷铜
 - Plating: Au G/F
电镀:金 G/F
 - Insulation Material: PA6T, UL94V-0
绝缘材料:PA6T, UL94V-0
 - Marked "*" symbol are major dimensions
标有 "*" 符号为主要尺寸
 - Packing: 300Bag+Box;
包装: 300袋+盒;

PIN	DIM A	DIM B
1x1P	1.67	
1x2P	2.94	1.27
1x3P	4.21	2.54
1x4P	5.48	3.81
1x5P	6.75	5.08
1x6P	8.02	6.35
1x7P	9.29	7.62
1x8P	10.56	8.89
1x9P	11.83	10.16
1x10P	13.10	11.43
1x11P	14.37	12.70
1x12P	15.64	13.97
1x13P	16.91	15.24
1x14P	18.18	16.51
1x15P	19.45	17.78
1x16P	20.72	19.05
1x17P	21.99	20.32
1x18P	23.26	21.59
1x19P	24.53	22.86
1x20P	25.80	24.13
1x21P	27.07	25.4
1x22P	28.34	26.67
1x23P	29.61	27.94
1x24P	30.88	29.21
1x25P	32.15	30.48
1x26P	33.42	31.75
1x27P	34.69	33.02
1x28P	35.96	34.29
1x29P	37.23	35.56
1x30P	38.50	36.83
1x31P	39.77	38.10
1x32P	41.04	39.37
1x33P	42.31	40.64
1x34P	43.58	41.91
1x35P	44.85	43.18
1x36P	46.12	44.45
1x37P	47.39	45.72
1x38P	48.66	46.99
1x39P	49.93	48.26
1x40P	51.20	49.53

Ordering Information

LFH 127 X XX X XXXX

Code	Pitch	Rows	PIN Number	Packing	Serial No
FH:FEMALE HEADER 排母	100:1.0 127:1.27 200: 2.0 250:2.5 254: 2.54	1:1Row单排 2:2Row双排 3:3Row三排 4:4Row四排	PIN数 ~99 (Per Row每排)	A:PE Bag 袋装 B:Tube 管装 C:Troy 盘装 D:Reel 卷装 E:Bag and Box 袋加盒 F:Other其他	0001~9999

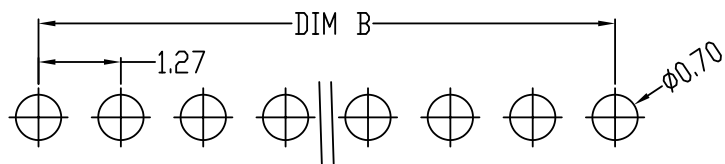

PCB LAYOUT

STANDARD TOLERANCE (EXCEPT SPECIFIED)	
LINER	ANGLES
.0 ±0.30	0.° ±3°
.00 ±0.20	.0° ±2°
.000 ±0.10	.00° ±1°

LDCONN 东莞连大精密制品有限公司
DongGuan LianDa Precision Products Co., LTD

TITLE	PH1.27X4.3 1X16P 180°单排排母U型	DRAWN BY	LZR	05/13-'22
PART NO	LFH127116C0001	CHECKED BY	工程 7-11-22 朱磊	
DRAWING NO		APPROVED BY	工程 7-11-22 周晓	
SCALE	1:1	UNIT	mm	PAGE 1/1
				SIZE A4

HSF RoHS

REV	ECN NO	DESCRIPTION	DATE	NAME
A	—	NEW	07/27-22	LJS

Specifications

规范

- Current Rating: 1.0Amps
额定电流:1.0安培
- rated voltage: 125V AC/DC
额定电压:125V AC/DC
- Insulation Resistance: 1000 MΩ Min
绝缘电阻:最小1000 MΩ
- Dielectric withstanding Voltage: 500V AC
耐电压:500V AC
- Contact Resistance: 20 mΩ Max
接触电阻:最大20 mΩ
- Operating Temperature: -40° C to+105° C
工作温度:-40° C ~ +105° C
- Contact Material:Phosphor Bronze
接触材质:磷铜
- Plating:AU G/F Over Ni
电镀:金 G/F 加镍底
- Insulation Material:PA6T, UL94V-0, Black
绝缘材料:PA6T, UL94V-0, 黑色
- Marked "*" symbol are major dimensions
标有 "*" 符号为主要尺寸
- Packing:300PCS/Bag+Box
包装: 300PCS/袋+盒装

Ordering Information

LXX XXX X XX X XXXX

Code	Pitch	Rows	PIN Number	Packing	Serial No
PH: PIN HEADER 排针	100:1.0	1:1Row单排	PIN数	A:PE Bag 袋装	0001~9999
FH:FEMALE HEADER 排母	127:1.27	2:2Row双排	1~99	B:Tube 管装	
BH:EJECTOR HEADER 筒半	200:2.0	3:3Row三排	(Per Row每排)	C:Tray 盘装	
EH:BOX HEADER 牛角	250:2.5	4:4Row四排		D:Reel 卷装	
	254:2.54			E:Bag and Box 袋加盒	
				F:Other其他	

PIN	DIM A	DIM B
1x1P	1.77	
1x2P	3.04	1.27
1x3P	4.31	2.54
1x4P	5.58	3.81
1x5P	6.85	5.08
1x6P	8.12	6.35
1x7P	9.39	7.62
1x8P	10.66	8.89
1x9P	11.93	10.16
1x10P	13.20	11.43
1x11P	14.47	12.70
1x12P	15.74	13.97
1x13P	17.01	15.24
1x14P	18.28	16.51
1x15P	19.55	17.78
1x16P	20.82	19.05
1x17P	22.09	20.32
1x18P	23.36	21.59
1x19P	24.63	22.86
1x20P	25.90	24.13
1x21P	27.17	25.4
1x22P	28.44	26.67
1x23P	29.71	27.94
1x24P	30.98	29.21
1x25P	32.25	30.48
1x26P	33.52	31.75
1x27P	34.79	33.02
1x28P	36.06	34.29
1x29P	37.33	35.56
1x30P	38.60	36.83
1x31P	39.87	38.10
1x32P	41.14	39.37
1x33P	42.41	40.64
1x34P	43.68	41.91
1x35P	44.95	43.18
1x36P	46.22	44.45
1x37P	47.49	45.72
1x38P	48.76	46.99
1x39P	50.03	48.26
1x40P	51.30	49.53

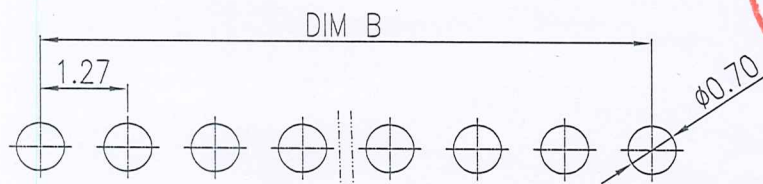
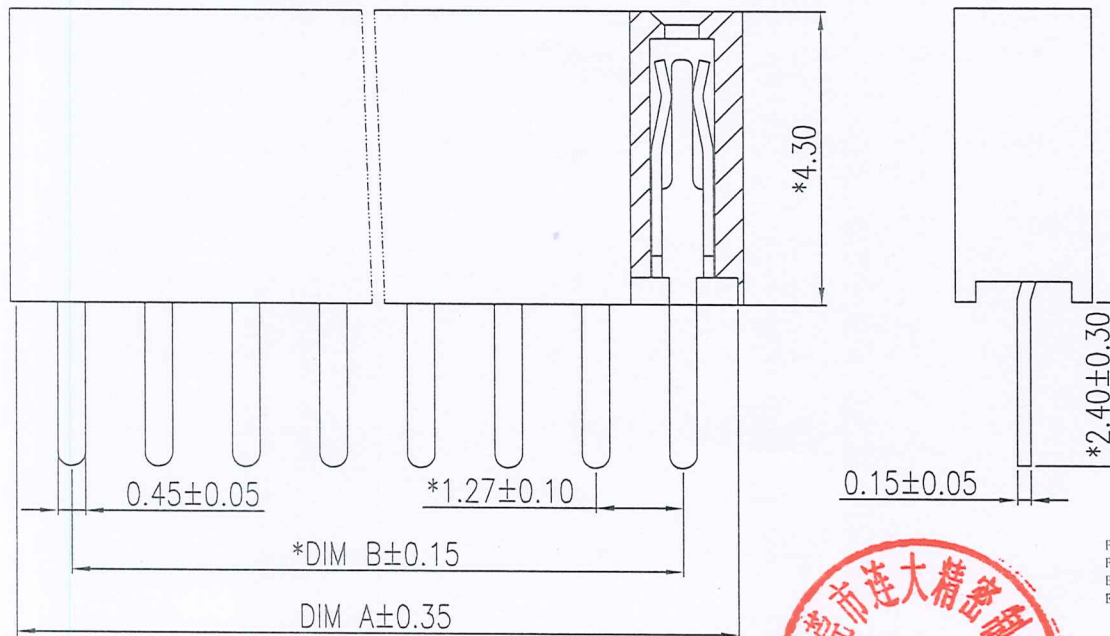
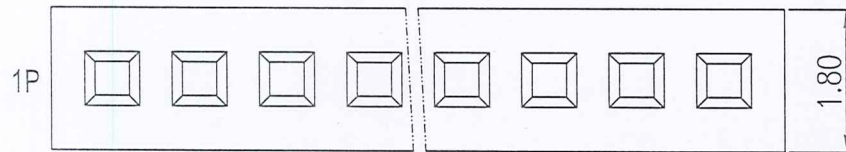

PCB LAYOUT



STANDARD TOLERANCE (EXCEPT SPECIFIED)

LINER	ANGLES
.0 ±0.30	0° ±3°
.00 ±0.20	.0° ±2°
.000 ±0.10	.00° ±1°

LDCONN 东莞连大精密制品有限公司
DongGuan LianDa Precision Products Co., LTD

TITLE	PH1.27X4.3 1X19P 180°单排排母U型	DRAWN BY	LJS	07/27-22
PART NO.	LFH127119C0001	CHECKED BY	ZL	9/18-24
DRAWING NO.	—	APPROVED BY	ZX	7/20-24
SCALE	UNIT	mm	PAGE	SIZE A 4